

**+Plus FREE Consultation**

# Water Quality Test Kit

## 3-in-1 TDS Pen

## 16-in-1 Water Test Strips

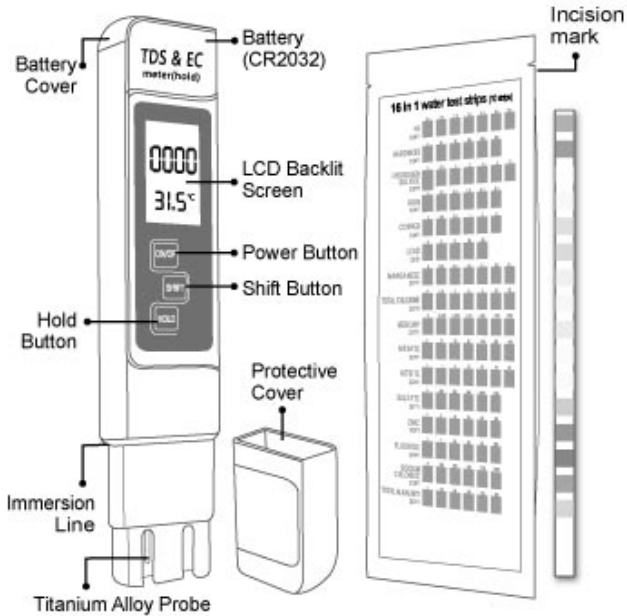

### Application

Suitable for all kinds of water quality testing, water purification applications, swimming pools, aquariums, aquaculture, hydroponic agriculture, laboratory, scientific usage, ecological testing, wastewater conditioning, etc.

### Please Note Before Use

1. Avoid touching or polluting the test area of the test strip and TDS probe.
2. Do not touch the test kit or TDS Pen with wet fingers.
3. Once the water test strips package is opened, use them promptly. It is recommended that you use test strips from an unopened pack for the most accurate results.
4. Do not use the test strip or TDS pen in hot boiling water.
5. Not suitable for measuring flowing or fluctuating water.
6. Each region and city have different test results due to pipes and water sources.

### 3-in-1 TDS Pen Measurement Range

Parameters: TDS(Total Dissolved Solids), EC(Conductivity), Temperature(Fahrenheit / Celsius)  
 TDS: 0~9999ppm  
 Conductivity: 0~9990 $\mu$ s/cm  
 Temperature: 0.1 $^{\circ}$ C~80.0 $^{\circ}$ C / 32.0 $^{\circ}$ F~176.0 $^{\circ}$ F  
 Accuracy:  $\pm$ 2%  
 Battery Type: 1 \* 3V / CR2032

### Modes Shifting

Press the "**SHIFT**" key to shift automatically between the following four display modes :

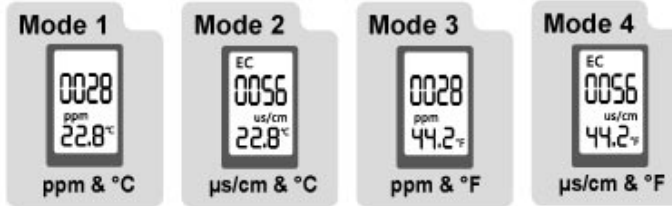

- \*The device will automatically memorize the last mode when it restarts.
- \*The device has an automatic temperature compensation function.

### Measure Result Locking

Press the "**HOLD**" key, the unit will lock the measurement results for 5 minutes. After the value is locked:  
 → To convert the value to a different mode, press "**SHIFT**".  
 → To unlock the measured value, press "**HOLD**" again.

### Automatic Power Saving

The device will automatically shut off to save power after 5 min without action.

### TDS&EC Pen Instructions

1. Open the protection cap of the probe.
2. Press the "**ON/OFF**" button to turn on the TDS pen.
3. Dip the pen into water (the water level should not be over the immersion line), hold the pen till the numbers on the display are steady, then press the "**HOLD**" button and record the parameters.
4. Keep the probe dry and clean after use. Placing back the cap.

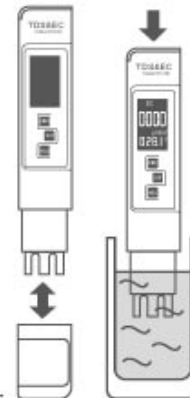

### Water Test Strip Instructions

1. Carefully tear the foil bag open from the mark, do not touch the reaction area of the test strip.
2. Dip the strip into water for 1 - 2 seconds and then remove the strip. Gently, let any excess water drip off.
3. Immediately compare the strip to the color chart. Please ensure to record the parameters in 1 minute.
5. For best results read in natural daylight.
4. We recommend performing the 16-in-1 test strip at least two times per occasion and averaging your results. This will reduce the potential for user error.

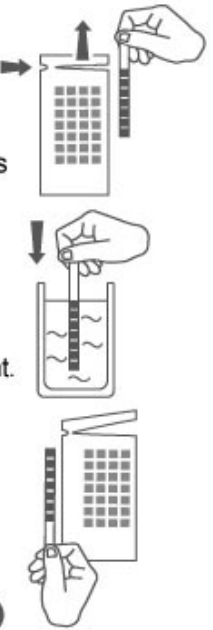

### Getting Free Water Treatment Advice

1. Complete the "The Water Quality Test Kit Record Chart" attached on the back.
2. Scan the QR code and fill out the form.
3. Submit the form. We will advise you on the water treatment you need based on the test records.



### Maintenance & Storage

1. Store the Water Test Kit in a cool, dry place, away from high temperatures and direct sunlight.
2. Unopened Water Test Strips in sealed foil bags can be stored for a year in a clean, cool, and dry place.
3. Once the foil package is opened, use them promptly! They can be stored in a sealed bag for about 30 days, but humidity and temperature can still affect their accuracy. It is recommended that you use test strips from an unopened pack for the most accurate results.
4. After use, ensure the TDS pen is clean and dry, and put on the protective cover. Remove the battery if not in use for an extended period.
5. The TDS pen is a professional instrument, please handle it professionally. It is not waterproof, so avoid submerging it beyond the immersion line, subjecting it to excessive force, or dropping it, as these actions can damage the instrument.

## The Water Quality Test Kit Record Chart

17 Parameters	Test 1 Date : / /	Test 2 Date : / /	Test 3 Date : / /	WQA Standards for Drinking Water	Comments
TDS	ppm	ppm	ppm	< 500 ppm	
pH				6.5 - 8.5	
Hardness (TH)	ppm	ppm	ppm	< 500 ppm	
Hydrogen Sulfide(H <sub>2</sub> S)	ppm	ppm	ppm	< 0 ppm	
Iron (Fe)	ppm	ppm	ppm	< 0.3 ppm	
Copper (Cu)	ppm	ppm	ppm	< 1 ppm	
Lead (Pb)	ppb	ppb	ppb	< 15 ppb	
Manganese (Mn)	ppm	ppm	ppm	< 0.1 ppm	
Total Chlorine (TC)	ppm	ppm	ppm	< 3 ppm	
Mercury (Hg)	ppm	ppm	ppm	< 0.002 ppm	
Nitrate (NO <sub>3</sub> )	ppm	ppm	ppm	< 10 ppm	
Nitrite (NO <sub>2</sub> )	ppm	ppm	ppm	< 1 ppm	
Sulfate (SO <sub>4</sub> )	ppm	ppm	ppm	< 200 ppm	
Zinc (Zn)	ppm	ppm	ppm	< 5 ppm	
Fluoride (F)	ppm	ppm	ppm	< 4 ppm	
Sodium Chloride (NaCl)	ppm	ppm	ppm	< 250 ppm	
Total Alkalinity (TA)	ppm	ppm	ppm	< 180 ppm	

We recommend performing the 16-in-1 test strip at least two times per occasion and averaging your results. This will reduce the potential for user error.

Note: ppm = mg/l